

SOIL BORING CORE LOCATIONS*

- 1 = LS-6187
- 2 = LS-6188 & LS-6189
- 3 = LS-6190
- 4 = LS-6191
- 5 = LS-6192 & LS-6193
- 6 = LS-6194

*SEE MISSIMER REPORT

SITE DATA:

- 1803.50 AC. = TOTAL SITE AREA
- 814.38 AC. = FDEP JURISDICTIONAL WETLAND AREA (INCLUDES, BUT NOT SHOWN ON PLAN, 42.00 ACRES OF INTERIOR FARM DITCHES)
- 190.83 AC. = IMPACTS TO FDEP JURISDICTIONAL WETLAND AREA (INCLUDES, BUT NOT SHOWN ON PLAN, IMPACTS TO ALL OF THE 42.00 ACRES OF INTERIOR FARM DITCHES)
- 769.06 AC. = USACOE JURISDICTIONAL WETLAND AREA
- 145.52 AC. = IMPACTS TO USACOE JURISDICTIONAL WETLAND AREA
- 351.70± AC. = MINING PIT AREA #1
- 445.81± AC. = MINING PIT AREA #2

SITE AREAS:

- 1803.50 AC. = TOTAL SITE AREA
- 623.55 AC. = PRESERVED WETLANDS
- 797.51 AC. = MINING PITS
- 10.70 AC. = EX. BLDGS. AT ENTRANCE
- 22.38 AC. = ADM./ TRUCK SCALES
- 22.84 AC. = MAINTENANCE BUILDING SITE
- 10.00 AC. = EX. BLDGS. NEAR MAINT. BLDG.
- 68.00 AC. = PROCESSING AREA
- 7.00 AC. = ENTRANCE ROAD
- 241.52 AC. = WILDLIFE CORRIDOR, BUFFERS AND NOT MINED AREAS

INDIGENOUS VEGETATION AREAS:

- TOTAL SITE AREA = 1803.50 AC.
- INDIGENOUS VEGETATION REQUIRED = 450.88 AC. (1803.50 AC. X 25%)
- INDIG. VEG. TO BE PRESERVED = 541.268 AC. (SEE SHEET 31)

WETLANDS AREA	FDEP		WETLAND PRESERVED		USACOE		WETLAND PRESERVED	
	AREA	IMPACTS	AREA	IMPACTS	AREA	IMPACTS	AREA	IMPACTS
W-1	12.37 AC	0.17 AC	12.20 AC	0.00 AC	W-1	12.37 AC	0.17 AC	12.20 AC
W-2	0.75 AC	0.75 AC	0.00 AC	0.00 AC	W-2	0.75 AC	0.75 AC	0.00 AC
W-3	2.61 AC	1.31 AC	1.30 AC	0.00 AC	W-3	2.61 AC	1.31 AC	1.30 AC
W-4	28.91 AC	0.78 AC	28.18 AC	0.00 AC	W-4	28.91 AC	0.78 AC	28.18 AC
W-5A	5.34 AC	0.00 AC	5.34 AC	0.00 AC	W-5A	5.34 AC	0.00 AC	5.34 AC
W-5B	0.58 AC	0.24 AC	0.34 AC	0.00 AC	W-5B	0.58 AC	0.24 AC	0.34 AC
W-6	219.12 AC	8.60 AC	210.52 AC	0.00 AC	W-6	219.12 AC	8.60 AC	210.52 AC
W-7	43.28 AC	13.98 AC	29.28 AC	0.00 AC	W-7	43.28 AC	13.98 AC	29.28 AC
W-8	12.30 AC	12.30 AC	0.00 AC	0.00 AC	W-8	12.30 AC	12.30 AC	0.00 AC
W-8A	0.63 AC	0.63 AC	0.00 AC	0.00 AC	W-8A	0.63 AC	0.63 AC	0.00 AC
W-9	0.84 AC	0.00 AC	0.84 AC	0.00 AC	W-9	0.84 AC	0.00 AC	0.84 AC
W-10A	139.00 AC	0.00 AC	139.00 AC	0.00 AC	W-10A	139.00 AC	0.00 AC	139.00 AC
W-10B	15.57 AC	15.57 AC	0.00 AC	0.00 AC	W-10B	15.57 AC	15.57 AC	0.00 AC
W-11	8.31 AC	0.00 AC	8.31 AC	0.00 AC	W-11	8.31 AC	0.00 AC	8.31 AC
W-12	7.79 AC	0.00 AC	7.79 AC	0.00 AC	W-12	7.79 AC	0.00 AC	7.79 AC
W-13	27.51 AC	0.00 AC	27.51 AC	0.00 AC	W-13	27.51 AC	0.00 AC	27.51 AC
W-14	119.88 AC	0.00 AC	119.88 AC	0.00 AC	W-14	119.88 AC	0.00 AC	119.88 AC
W-15	5.06 AC	0.00 AC	5.06 AC	0.00 AC	W-15	5.06 AC	0.00 AC	5.06 AC
W-16	14.75 AC	0.00 AC	14.75 AC	0.00 AC	W-16	14.75 AC	0.00 AC	14.75 AC
W-17	31.30 AC	31.30 AC	0.00 AC	0.00 AC	W-17	31.30 AC	31.30 AC	0.00 AC
W-18	3.41 AC	0.00 AC	3.41 AC	0.00 AC	W-18	3.41 AC	0.00 AC	3.41 AC
W-19	73.05 AC	63.17 AC	9.88 AC	0.00 AC	W-19	73.05 AC	63.17 AC	9.88 AC
Farm Ditch	42.00 AC	42.00 AC	0.00 AC	0.00 AC				
TOTAL	814.38 AC	190.83 AC	623.55 AC		TOTAL	769.06 AC	145.52 AC	623.54 AC

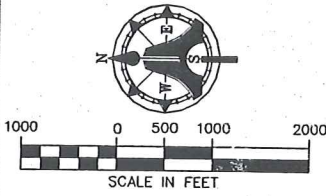

LAT. 26°29'26.05" N.
LONG. 81°37'18.52" W.
SECTIONS 28 AND 33, T45S, R27E
SECTIONS 4, 9, 16 & 21, T46S, R27E
SOUTHEAST LEE COUNTY, FLORIDA

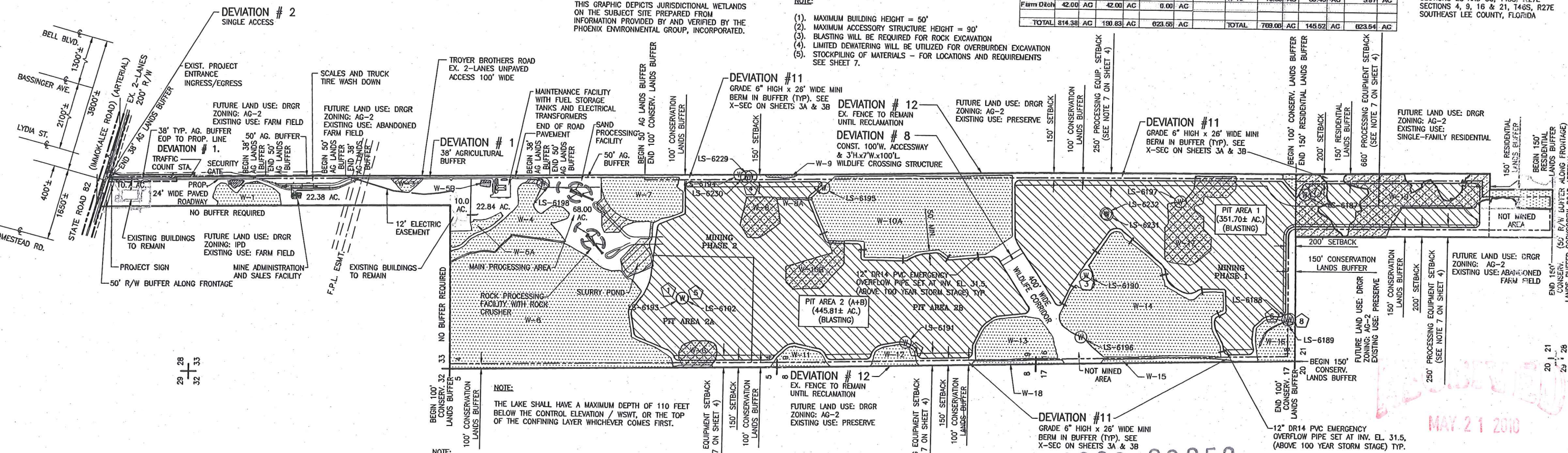

- DEVIATION # 1: AGRICULTURAL BUFFER (SEE THIS SHEET AND 30).
- DEVIATION # 2: SINGLE ACCESS (SEE THIS SHEET AND 30).
- DEVIATIONS # 3-5: WITHDRAWN.
- DEVIATION # 6: LITTORAL ZONE (SEE SHEET 29 & 30).
- DEVIATION # 7: RECLAMATION PHASING (SEE SHEET 29 & 30).
- DEVIATION # 8: WILDLIFE CORRIDOR CROSSING (SEE THIS SHEET & 30).
- DEVIATION # 9: BOULDERS FOR WAVE ENERGY DISSIPATION (SEE SHEET 29 & 30).
- DEVIATION #10: POST MINE EXCAVATION WITHIN SETBACK (SEE SHEET 29 & 30).
- DEVIATION #11: GRADING IN BUFFER (SEE THIS SHEET & 30).
- DEVIATION #12: EXISTING FENCES TO REMAIN ALONG PROPERTY LINES UNTIL RECLAMATION

- 6 4/20/10 ADDED DEVIATION #12
- 5 1/12/10 ADDED WETLAND INFORMATION; REVISED WELLS

NO.	DATE	REVISION
4	12/17/09	REV. INDIGENOUS VEGETATION REQUIREMENTS; ADDED DEV. 10&11
3	12/1/09	REV. W-19; SITE DATA, SITE AREAS Tables; BUFFER LIMITS; DEV. #10
2	8/31/09	REVISED PER LEE Co. COMMENTS.
1	4/06/09	REVISED PER LEE Co. COMMENTS.

NOT AUTHORIZED FOR CONSTRUCTION UNLESS SIGNED IN THIS BLOCK



AIM Engineering & Surveying, Inc.
UTILITIES • TRANSPORTATION • LAND DEVELOPMENT • PROJECT MANAGEMENT
100 MADRID BOULEVARD, SUITE 111
PUNTA GORDA, FLORIDA 33550
E-Mail: engineering@aimeng.com
TELE: 841-347-7403
FAX: 841-347-7408
CERTIFICATION OF AUTHORIZATION No. 3114

TROYER BROTHERS FLORIDA, INC.
14700 TROYER BROS. RD, FORT MYERS, FLORIDA 33913
PHONE: (239) 860-3728 FAX: (239) 303-1297

SCALE: AS-NOTED
DATE: AUG. 12, 2009.
SHEET: 3
JUR/REK/FDW

TROYER BROTHERS MINE
MINING & EXCAVATION PLAN (1)

NOTE:
THE LAKE SHALL HAVE A MAXIMUM DEPTH OF 110 FEET BELOW THE CONTROL ELEVATION / WSWT, OR THE TOP OF THE CONFINING LAYER WHICHEVER COMES FIRST.

- NOTE:**
- NOT MINED AREA No.1 AND No.2 SHALL REMAIN AT EXISTING GRADE.
 - CONSTRUCT PERIMETER BUFFERS IN ACCORDANCE WITH LDC-CH.12.
 - ELEVATIONS AND INVERTS ARE BASED ON NGVD 1929.
 - THE CONVERSION FACTOR IS (-1.20') TO NAVD OF 1988.

MINE CONSTRUCTION AND OPERATIONS PHASING PLAN:

BONA FIDE AGRICULTURAL ACTIVITIES MAY CONTINUE ON-SITE UNTIL ISSUANCE OF THE MINE OPERATING PERMIT (MOP). ALL EXISTING STRUCTURES WILL REMAIN ON THE PROPERTY. THESE STRUCTURES WILL CONTINUE TO BE UTILIZED FOR BONA FIDE AGRICULTURAL USES UNTIL ISSUANCE BY LEE COUNTY OF A MINE OPERATING PERMIT (MOP) FOR THE PROPERTY. THEREAFTER, UPON ISSUANCE OF THE MOP FOR THE PROPERTY, AGRICULTURAL OPERATIONS WILL TERMINATE AND, IF THE NOW EXISTING STRUCTURES ARE TO BE UTILIZED, THE PROPERTY OWNER WILL SUBMIT DETAILED ENGINEERING PLANS DEPICTING COMPLIANCE WITH APPLICABLE CODES AND REGULATIONS IN PLACE AT THAT TIME.

INITIAL CONSTRUCTION OF THE MINE INFRASTRUCTURE WILL BEGIN UPON ISSUANCE BY LEE COUNTY OF A MINE DEVELOPMENT ORDER (MDO). THIS INITIAL CONSTRUCTION WILL CONSIST OF THE FOLLOWING:

- ENTRANCE IMPROVEMENTS ON S.R.82; THE PAVED ENTRANCE ROAD; SCALES AND TRUCK TIRE WASH DOWN; MINE ADMINISTRATION AND SALES FACILITIES; MAINTENANCE FACILITY AND FUEL STORAGE TANKS; WITH WILDLIFE CROSSING STRUCTURE; AND EROSION CONTROL FACILITIES.
- A PORTION OF PIT AREA 2A FOR THE EXCAVATION OF SAND AND LIMESTONE MATERIALS TO BE UTILIZED FOR THE CONSTRUCTION OF THE ON-SITE INFRASTRUCTURE AND THE S.R. 82 IMPROVEMENTS DESCRIBED IN PARAGRAPH 1, ABOVE. THE SAND AND ROCK PROCESSING FACILITIES SHALL BE ALLOWED TO OPERATE TO THE EXTENT NECESSARY TO PROCESS THE MATERIALS FOR USE IN THE CONSTRUCTION OF THE INITIAL INFRASTRUCTURE AS DESCRIBED HEREIN. NO MATERIALS WILL BE REMOVED FROM THE SITE UNTIL AN MOP IS ISSUED BY LEE COUNTY.

THERE WILL BE TWO PRIMARY MINING PHASES ASSOCIATED WITH THE COMMERCIAL ACTIVITY OF THIS MINE AS FOLLOWS:

- MINING PHASE 1 IS THE MINING OF PIT AREA 1 AND THE REMAINDER OF PIT AREA 2A. MINING PHASE 1 WILL BEGIN UPON ISSUANCE OF THE MOP AND CONTINUE UNTIL THE COMPLETION OF THE EXCAVATION OF PIT AREA 1. ESTIMATED TIME FOR COMPLETION IS 17.5 YEARS.
- MINING PHASE 2 IS THE MINING OF PIT AREA 2B. MINING PHASE 2 WILL BEGIN UPON THE COMPLETION OF THE EXCAVATION OF PIT AREA 1. ESTIMATED TIME OF COMPLETION OF MINING PHASE 2 IS 17.5 YEARS FOLLOWING THE COMPLETION OF MINING PHASE 1.

DCI 2008-00050

NOTE:
PRIOR TO EXCAVATION IN AN AREA CONTAINING WELLS, WELLS SHALL BE PLUGGED AND ABANDONED BY FILLING FROM TOTAL DEPTH TO LAND SURFACE WITH PORTLAND CEMENT. THE PLUGGING SHALL BE PERFORMED BY A LICENCED WELL DRILLER IN ACCORDANCE WITH LEE COUNTY REGULATIONS. A PERMIT WILL BE REQUIRED FOR EACH ABANDONMENT.

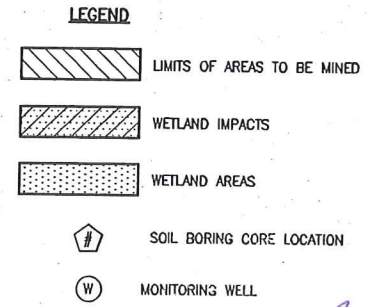

COMMUNITY DEVELOPMENT

MAY 21 2010

Ronald Kerfoot
4/22/2010
Ronald Kerfoot
P.E. No. 20768